

Sandwich Panel Production Line



Allbest Creative Development Ltd. (ALLBEST)

General Introduction

We professionally provide manufacture metal skinned heat-insulation **PU**, **Mineral Wool**, **Glass Wool** and **EPS Sandwich Panel Production Line**, as the key manufacturer in the field of Chinese heat insulation and sound insulation material.

Through our continuous development and effort on the technology and equipment, the Sandwich Panel Production Lines have been in the majority in Chinese market and exported to foreign countries.

Sandwich Panel Line (XBJ-VI, JG Series)



The line with laminator for corrugated sandwich panel mainly consist of roll forming machine and a sandwich panel laminating system. Through this line, corrugated sandwich panels can be produced directly, without the shortcoming that traditional corrugated sandwich panels have to be laminated manually after the forming of corrugated sheet. Moreover, both the roll forming machine and the laminating system can work independently. The roll forming machine of the line consists of feeding system, roll forming system and cutting system, while the laminating system is made up of such equipment as decoiler, feeding, squeezing, heating, laminating, edge rolling, edge turn-over, groove-making, edge pruning, pneumatic device, automatic cutting and PLC. The whole machine possesses advanced working process, integrated mechanical and electrical equipment. Annual production of this line is about 500,000 M² based on one shift working system.

Features of the Line:

1. Beautiful appearance, low noise, high efficiency;
2. Multiple functions: Besides corrugated sandwich panel, this line can be used to produce simple corrugated sheet;
3. The transmission of the main equipment is achieved by worm and worm gear which make the laminating speed smooth and steady;
4. The line employs advanced frequency control and cut the panel to length automatically;
5. The main body is welded with H steel with the fine surface treatment;
6. Rollers of the laminating system are covered with rubber to protect the surface of galvanized sheets and makes the smooth lamination.

Note:

The profiles and size of the panels shall be designed specially according to the requirement from the customer and our existing available technical sources

Main Specification of the Line:

1. Overall dimension of installation: 42 x 3.6 x 3.3 M (L x W x H)
2. PLC control
3. Installed power (incl. heating power): about 40 kW
4. Working speed: 1000-3000 mm/min (frequency control)
5. Working temperature: 25 °C
6. Density of EPS board: > 18 Kg/M³
7. Suitable material for production: 1000-1200 mm x (0.5-0.6 mm)

Application of the Finished Products:

The sandwich panels of this line are widely used as the roof and wall of factory, warehouse, garage, exhibition center, cinema, theatre, gymnasium, civil construction, stadium, cold storage, etc.

Sandwich Panel Line (SHYM Series)



EPS/Mineral Wool, 4 M/Min, Thickness of Panel: 50-250 mm; 1500-2000 M²/8 Hrs

Typical Layout of the Line

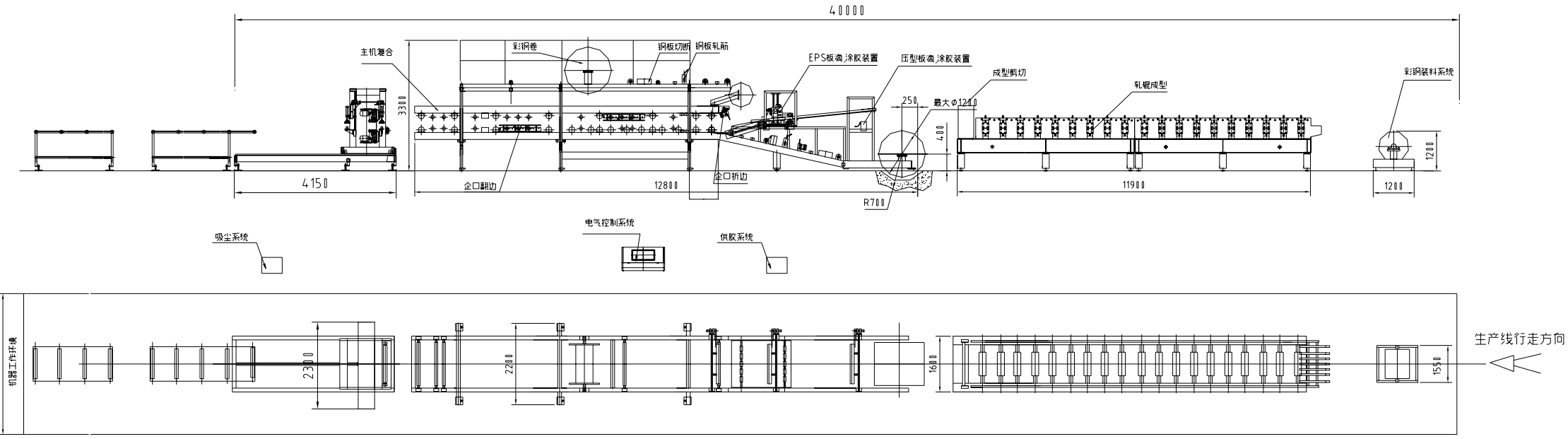



瓦楞成型机
Red forming machine ①



压型机
Roll forming machine ②

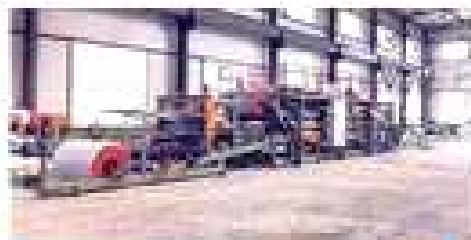

复合主机
Mainframe ③



切割机
cutting machine ④

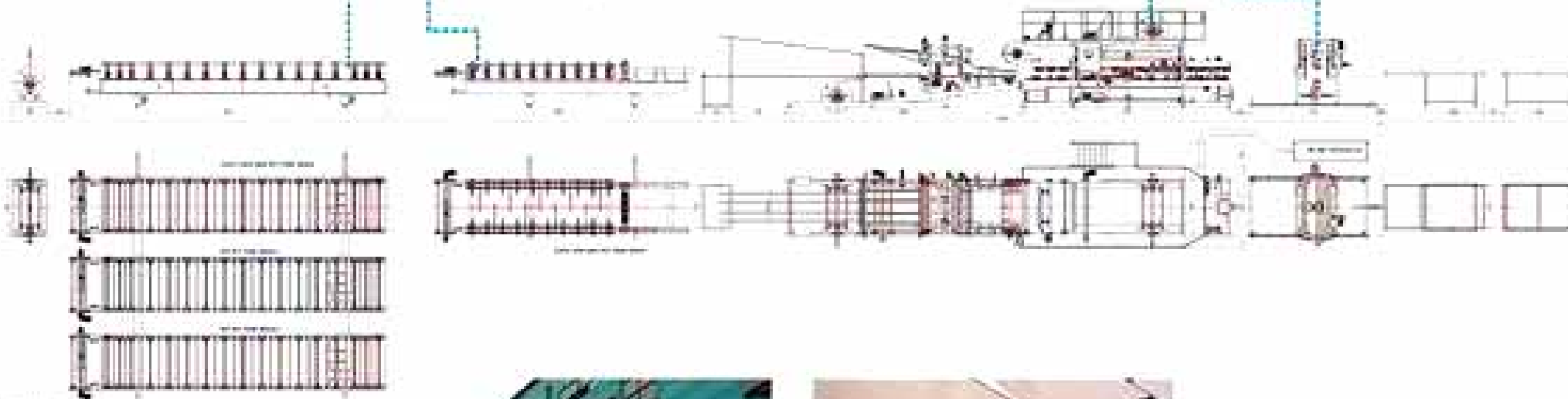

主要技术参数：(Primary technology parameters)

1. 主机生产速度：0-4.05米/分
1. The manufacturing speed of sandwich panel: 0-4.05m/min
2. 生产线外形尺寸：45200*8000*2800mm(长*宽*高)
2. The exterior size of product line: 45200*8000*2800mm (Length*width*height)
3. 生产线总装机容量：约50KW
3. Total power of the product line: about 50KW
4. 复合夹芯板厚度范围：50-250mm
4. Thickness of EPS sandwich panel: 50-250mm
5. 生产线生产能力：1500-2000m²/天
5. The output of the sandwich panel: 1500-2000m²/day



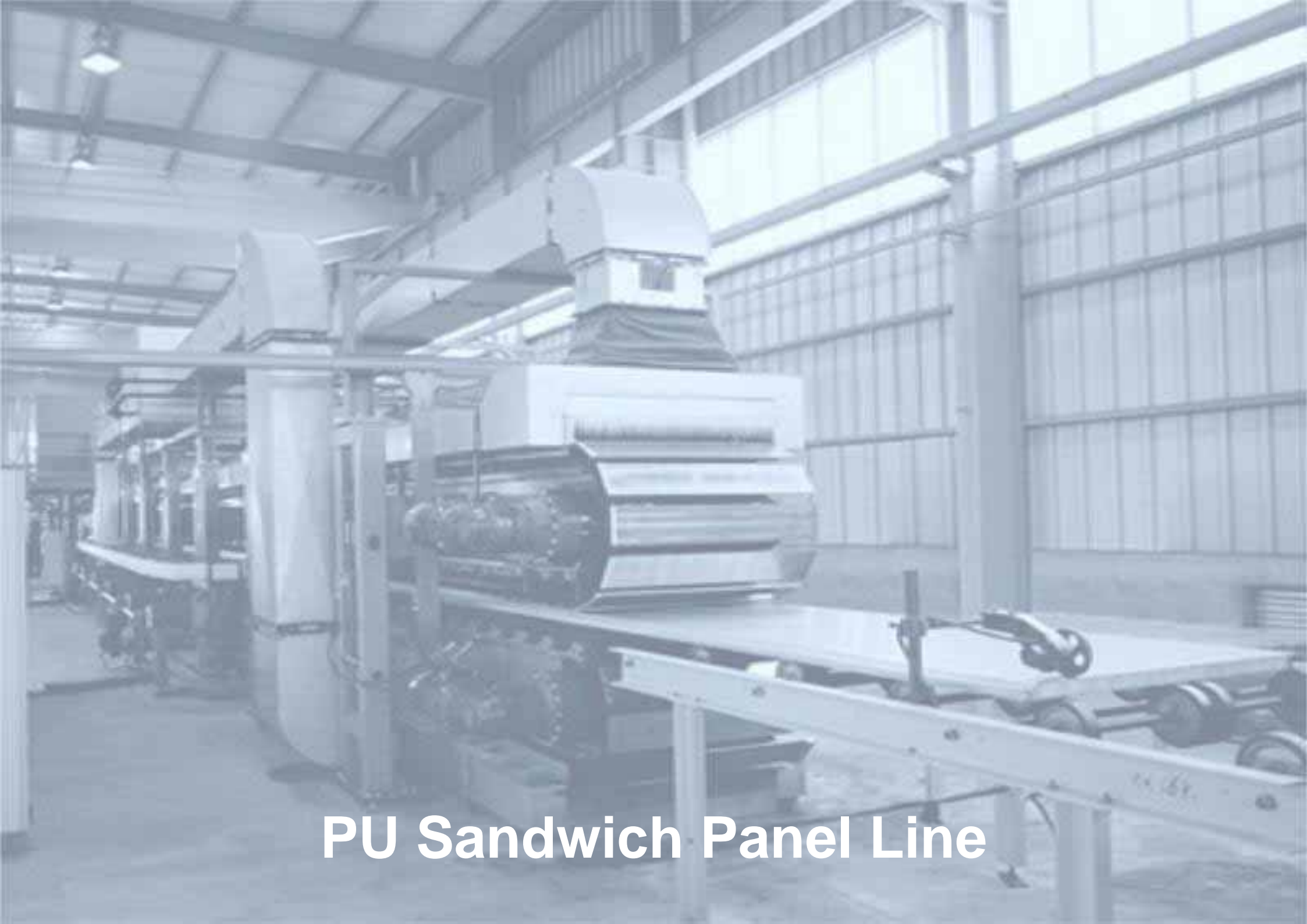

PU Sandwich Panel Line

PU sandwich panel line is an automatic production line, which is consisting of decoiler, coating, cutting equipment, roll forming system, preheating, foaming, solidification and stacking. The whole line integrates mechanics, chemistry, electrical control, pneumatic and temperature control

Application of the finished product:

Widely used in architecture and refrigeration industries as roof and wall panels for cold storage, thermal-control container, etc.

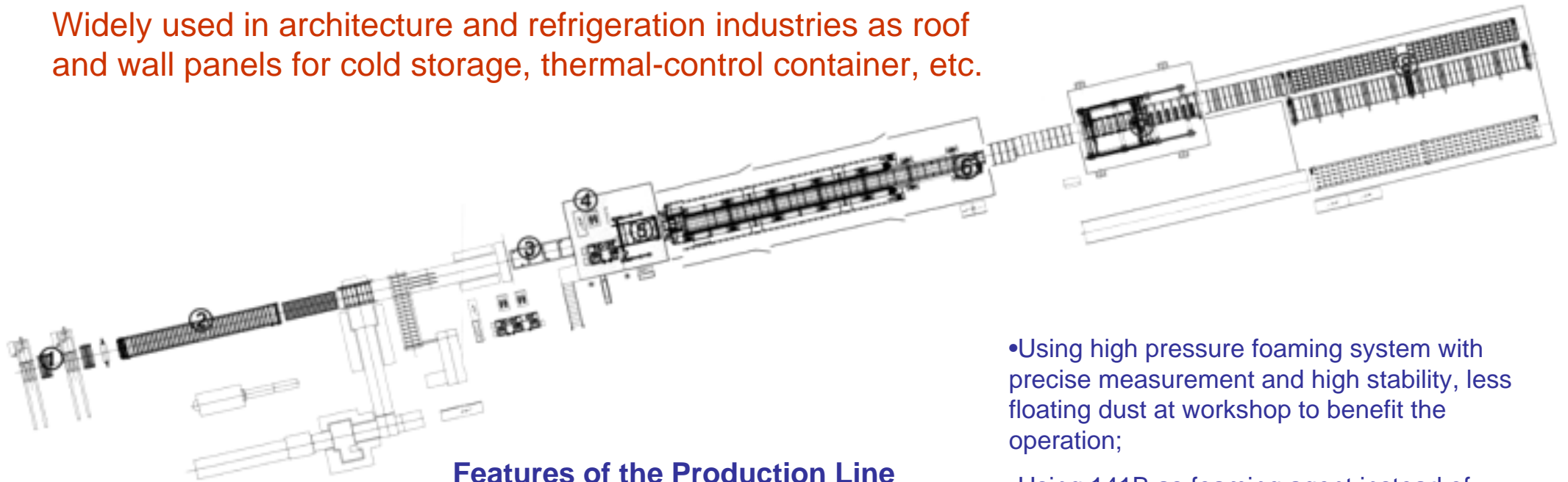

Features of the Production Line

- Beautiful looking and applicable to many fields with multiple functions, such as isolation of heat and sound, flame resistance, etc.;
- Using hot air recycle over, strictly control the temperature of PU foaming and solidification within requested range, so as to make sure the high quality of laminated panel;

- Using high pressure foaming system with precise measurement and high stability, less floating dust at workshop to benefit the operation;
- Using 141B as foaming agent instead of carbon chloral-fluoride, make the PU foaming treatment become environmental production process;
- Special double belt press, make sandwich panel with smooth surface, even thickness and anti-pattern;
- PLC control is adopted for simple operation



Decoiler



Roll Forming



Preheating



Hi_pressure Metering & Mixing



Mixing and Pouring



Double Belt Press



Belt Cutting



Stacking

Main Specification of PU Production Line

1. Size of Panel
 - Length: 3-16 M (any length can be cut by manual)
 - Width: 900-1020 mm
 - Thickness: 30-150 mm (Not include height of corrugated part)
2. Specification of Steel Sheet
 - Thickness: 0.4-0.8 mm
 - Max. Width: 1250 mm
 - Max. Weight: 5 tons
 - Internal diameter of coil: 508 mm, 620 mm
3. Production Speed: 3-7 m/min (adjustable)
4. Total dimension of the production line: 110 x 15 x 5 M (L x W x H)
5. Max. Working Height: 1200 mm (outlet of panel)
6. Effective length of double belt press: 21 M
7. Working pressure of pouring foam: 150-200 Bar (high pressure foaming)
8. Total power installed: about 300 kW

PU Sandwich Panel Production Line (SHYM Series)







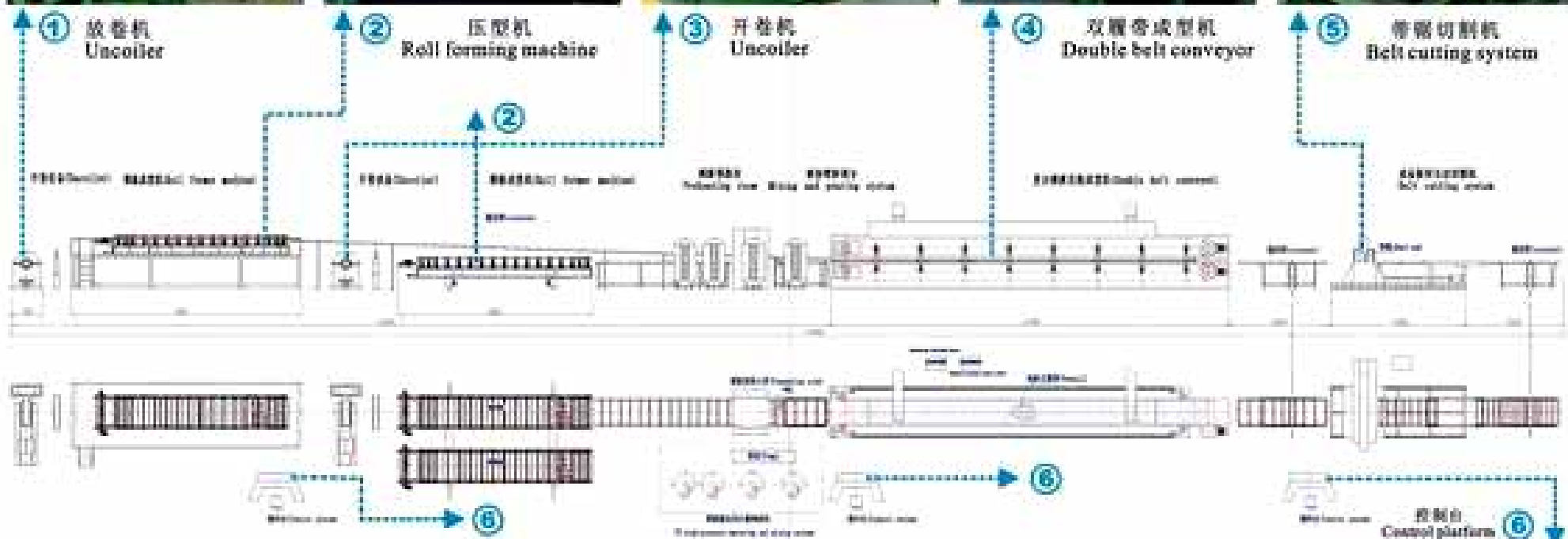

YMPU-PRL-1 型夹芯板生产线主要技术参数:
Primary technology parameters

- 1. 生产线传输速度: 最大速度8.8米/分钟 (变频调速);
 1 Speed of conveyor: maximal speed: 8.8m/min
- 2. 生产线总装机容量: 约150 KW;
 2 Total power of the product line: about 150KW
- 3. 板材宽度范围: 400-1250mm;
 3 Width of PU sandwich panel: 400-1250mm

- 4. 彩钢厚度范围: 0.4-0.8mm (其中不锈钢板厚度小于0.6mm);
 4 Thickness of steel sheet: 0.4-0.8mm (Thickness of stainless steel sheet be less than 0.6mm)
- 5. 聚氨酯复合夹芯板厚度范围: 30-200mm;
 5 Thickness of PU sandwich panel: 30-200mm
- 6. 生产线总长度: 约120米;
 6 Total length of the product line: about 120 meters
- 7. 双履带机长度: 24米;
 7 Length of double belt conveyor: 24m



Profiles

(Digested)

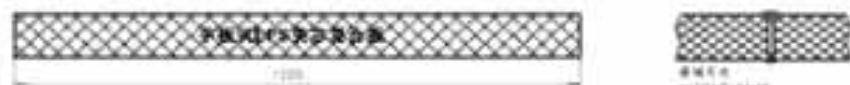

名称 Name	有效覆盖宽度(mm) Cover width	展开宽度(mm) Coll width	用途 Usage
平板PVC夹芯复合板 Aramid Type (PVC Sandwich Panel)	1200	1200	墙面板 Wall panel



名称 Name	有效覆盖宽度(mm) Cover width	展开宽度(mm) Coll width	用途 Usage
插入PVC夹芯复合板 Weld-in Type (PVC Sandwich Panel)	1150	1200	墙面板 Wall

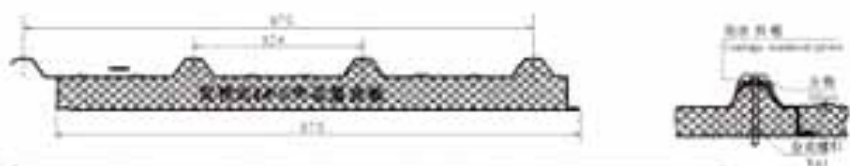

名称 Name	有效覆盖宽度(mm) Cover width	展开宽度(mm) Coll width	用途 Usage
瓦楞PVC夹芯复合板 Corrugation Type (PVC Sandwich Panel)	970	1200/1000	屋面板 Roof



名称 Name	有效覆盖宽度(mm) Cover width	展开宽度(mm) Coll width	用途 Usage
瓦楞PVC夹芯复合板 Corrugation Type (PVC Sandwich Panel)	990	1200/1000	墙面板 Wall

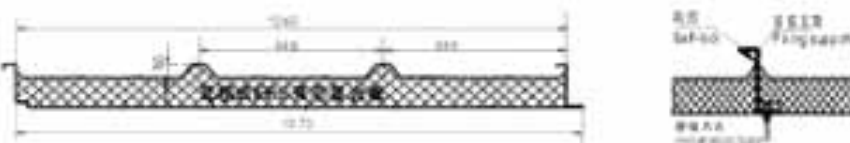

名称 Name	有效覆盖宽度(mm) Cover width	展开宽度(mm) Coll width	用途 Usage
瓦楞PVC夹芯复合板 Corrugation Type (PVC Sandwich Panel)	1040	1200/1040	屋面板 Roof



名称 Name	有效覆盖宽度(mm) Cover width	展开宽度(mm) Coll width	用途 Usage
插入PVC夹芯复合板 Weld-in Type (PVC Sandwich Panel)	1150	1200	墙面板 Wall



名称 Name	有效覆盖宽度(mm) Cover width	展开宽度(mm) Coll width	用途 Usage
插入PVC夹芯复合板 Weld-in Type (PVC Sandwich Panel)	1150	1200	墙面板 Wall

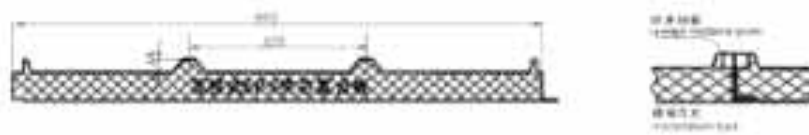

名称 Name	有效覆盖宽度(mm) Cover width	展开宽度(mm) Coll width	用途 Usage
瓦楞PVC夹芯复合板 Corrugation Type (PVC Sandwich Panel)	990	1200/1000	屋面板 Roof



名称 Name	有效覆盖宽度(mm) Cover width	展开宽度(mm) Coll width	用途 Usage
瓦楞PVC夹芯复合板 Corrugation Type (PVC Sandwich Panel)	990	1135/1000	墙面板 Wall

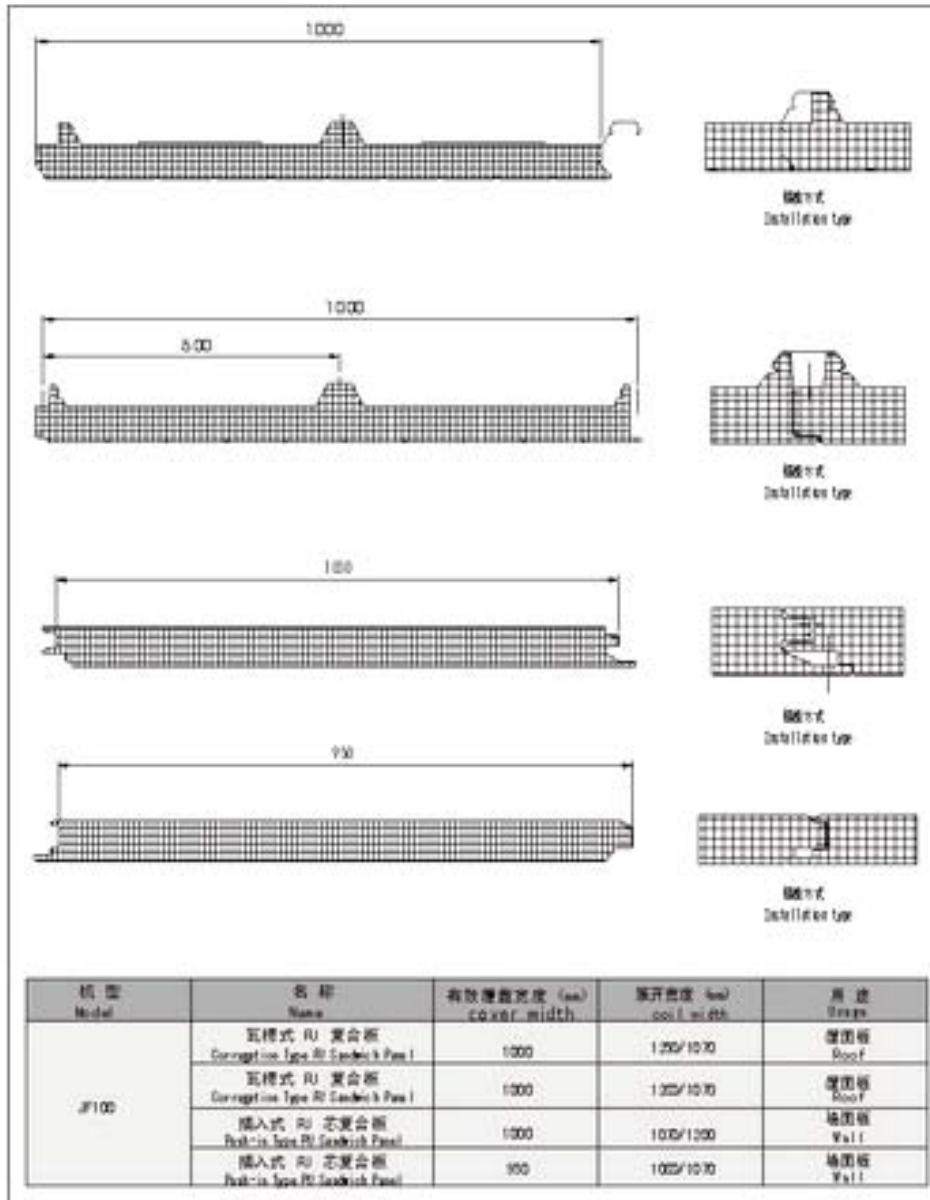

机型 Model	名称 Name	有效覆盖宽度 (mm) Cover width	展开宽度 (mm) Coil width	用途 Usage
XBJ-II	平板式 EPS 芯复合板 Aerolon Type EPS Sandwich Panel	1200	1200	屋面板 墙面板 Roof wall
	插入式 EPS 芯复合板 Push-in Type EPS Sandwich Panel	1150	1200	墙面板 Wall
XBJ-III	平板式 EPS 芯复合板 Aerolon Type EPS Sandwich Panel	1200	1200	屋面板 墙面板 Roof wall
	插入式 EPS 芯复合板 Push-in Type EPS Sandwich Panel	1150	1200	墙面板 Wall
	瓦楞式 EPS 芯复合板 Corrugation Type EPS Sandwich Panel	970	1200/1000	屋面板 Roof
XBJ-IV	平板式 EPS 芯复合板 Aerolon Type EPS Sandwich Panel	1200	1200	屋面板 墙面板 Roof wall
	插入式 EPS 芯复合板 Push-in Type EPS Sandwich Panel	1150	1200	墙面板 Wall
	瓦楞式 EPS 芯复合板 Corrugation Type EPS Sandwich Panel	1040	1200/1086	屋面板 Roof
XBJ-V	平板式 EPS 芯复合板 Aerolon Type EPS Sandwich Panel	1200	1200	屋面板 墙面板 Roof wall
	插入式 EPS 芯复合板 Push-in Type EPS Sandwich Panel	1150	1200	墙面板 Wall
	瓦楞式 EPS 芯复合板 Corrugation Type EPS Sandwich Panel	941	1200/1000	屋面板 Roof
	瓦楞式 EPS 芯复合板 Corrugation Type EPS Sandwich Panel	950	1070/1000	墙面板 Wall
XBJ-VI	平板式 EPS 芯复合板 Aerolon Type EPS Sandwich Panel	1200	1200	屋面板 墙面板 Roof wall
	插入式 EPS 芯复合板 Push-in Type EPS Sandwich Panel	1150	1200	墙面板 Wall
	瓦楞式 EPS 芯复合板 Corrugation Type EPS Sandwich Panel	1040	1200/1086	屋面板 Roof
本机也可生产玻璃纤维毡 岩棉芯复合板				
XBJ-VII	平板式 EPS 芯复合板 Aerolon Type EPS Sandwich Panel	1200	1200	屋面板 墙面板 Roof wall
	插入式 EPS 芯复合板 Push-in Type EPS Sandwich Panel	1150	1200	墙面板 Wall
	瓦楞式 EPS 芯复合板 Corrugation Type EPS Sandwich Panel	980	1200/1000	屋面板 Roof
本机也可生产玻璃纤维毡 岩棉芯复合板				
XBJ-VIII	平板式 EPS 芯复合板 Aerolon Type EPS Sandwich Panel	1200	1200	屋面板 墙面板 Roof wall
	插入式 EPS 芯复合板 Push-in Type EPS Sandwich Panel	1150	1200	墙面板 Wall
	瓦楞式 EPS 芯复合板 Corrugation Type EPS Sandwich Panel	1040	1200/1086	屋面板 Roof
	瓦楞式 EPS 芯复合板 Corrugation Type EPS Sandwich Panel	980	1135/1000	墙面板 Wall
本机也可生产玻璃纤维毡 岩棉芯复合板				

(6)940 4峰搭挂式

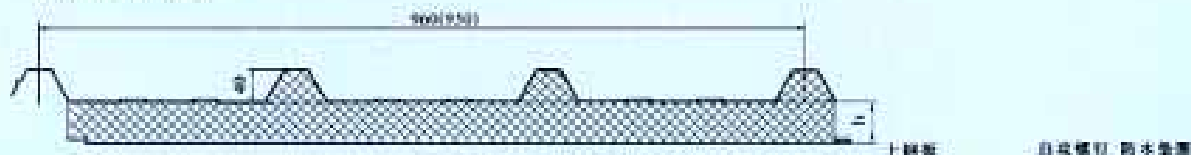

上钢板展开长度: 1200mm
下钢板展开长度: 1000mm
b=50~100mm
芯材: 聚苯乙烯(EPS)

(7)950 5峰搭挂式



上钢板展开长度: 1200mm
下钢板展开长度: 1000mm
b=50~100mm
芯材: 聚苯乙烯(EPS)

960 立体隐藏式凹凸墙板

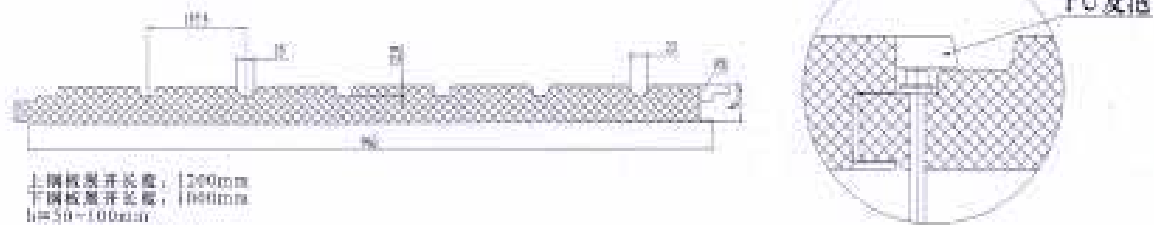

上钢板展开长度: 1200mm
下钢板展开长度: 1000mm
b=50~100mm
芯材: 聚苯乙烯(EPS)

1. 扣帽式埋板型

(1)940 4峰扣帽式埋板型



上钢板展开长度: 1200mm
下钢板展开长度: 1000mm
b=50~100mm
芯材: 聚苯乙烯(EPS)



扣帽式埋板埋板设计



上钢板展开长度: 1200mm
下钢板展开长度: 1000mm
b=50~100mm
芯材: 芯材



扣帽式埋板埋板设计



上钢板展开长度: 1200mm
下钢板展开长度: 1000mm
b=50~100mm
芯材: 芯材



扣帽式埋板埋板设计

(2)940 4峰扣帽式埋板型



上钢板展开长度: 1200mm
下钢板展开长度: 1000mm
b=50~100mm
芯材: 聚苯乙烯(EPS)



扣帽式埋板埋板设计



上钢板展开长度: 1200mm
下钢板展开长度: 1000mm
b=50~100mm
芯材: 芯材



扣帽式埋板埋板设计

1. EPS夹芯复合板

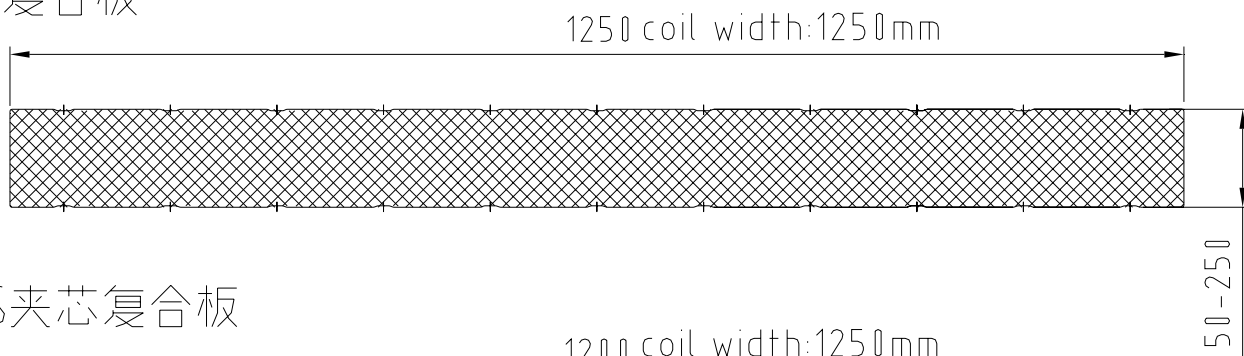

installation

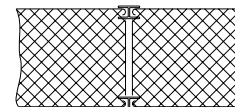

2.企口EPS夹芯复合板

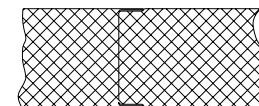
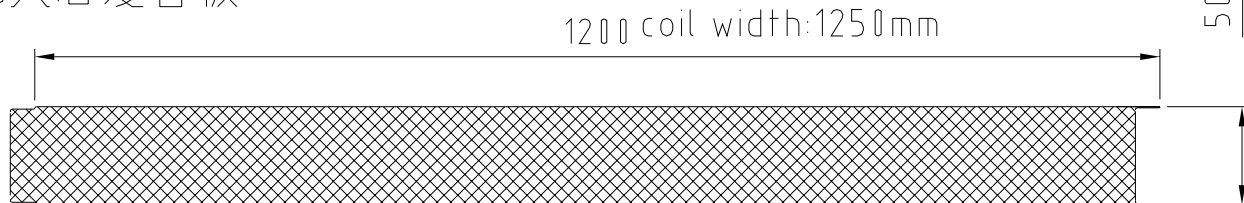

3. EPS夹芯瓦楞复合板:

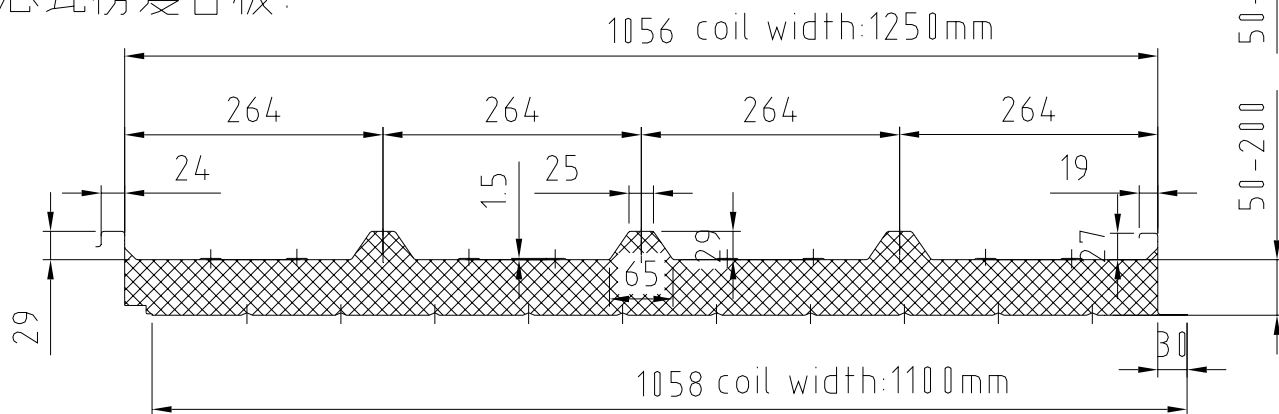

locking fastener

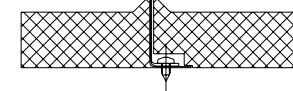



Application Samples of Sandwich Panel



SERVICES:

- **Procurement, manufacture, and delivery of the equipment**
- **Project Recommendation**
- **Technical service**
- **Training program**
- **After-sales service**
- **Other services and functions upon request**

HIGH-CLASS PRODUCTS AND SERVICES AT COMPETITIVE CHINA PRICES

CREATE THE FUTURE



Allbest Creative Development Ltd. (ALLBEST)

Beijing, China

allbest@china.com